



NIMACO

2018



www.nimacochemicals.com

Our mission



01

“Nimaco commits itself to providing products and services that consistently exceed the requirements and expectations of customers within the construction and specialty chemical product industry.”

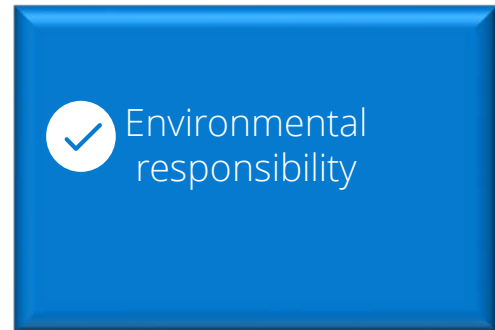
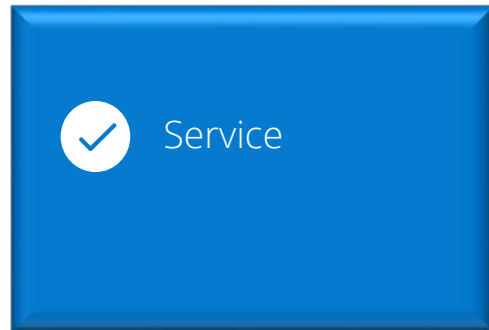
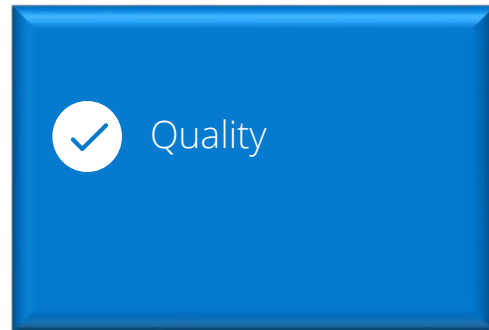

NIMACO: Waterproofing Systems

www.nimacochemicals.com

What we do



NIMACO: Waterproofing Systems



Nimaco is constantly developing, its range of products to bring innovation and effectiveness solutions to the building site. Nimaco has a wide range of products, such as:

- ✓ Waterproofing Systems
- ✓ Floor Coating Polyurethane and Epoxy Systems
- ✓ Industrial Systems
- ✓ Systems for Sports fields and Landscaping
- ✓ Marine Systems

The need of new products and solutions is detected and studied by the R&D continuously mainly through a direct team work on the production plants.

Our objective



NIMACO means looking for advanced solutions that guarantee unique features, and superior results. We are proud to say that their unique character does not stem just from their compliance with users' health requirements or from Nature protection, but also from their ability to obtain unsurpassed performance results in terms of easy application, resistance, durability and consumption.

Embracing NIMACO means discovering a world of exclusive, safe technology with plenty of advantages and constant research and development activities in order to provide increasingly useful tools and solutions to the complex modern building industry. We believe in a better world and we will unrelentingly work to pursue balance between technology, the environment and Man.

Target markets worldwide

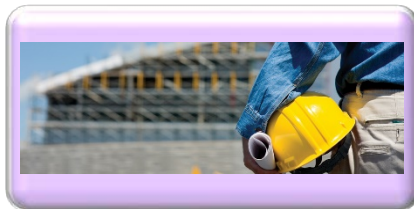

**Professional
Waterproofing
Applicators**

**Waterproofing
Products
Distribution**

**OEM / Private
Label**

Our Value



04



We add value by providing
Innovative Products
that are
Easy to Use,
Stable
and fulfill the
Cost Dimension
of the Construction Industry
without
Compromising Technical
Performance



Extreme climates resistant

Our products are suitable in all and different extreme conditions:

MAC SYSTEM ADVANTAGES

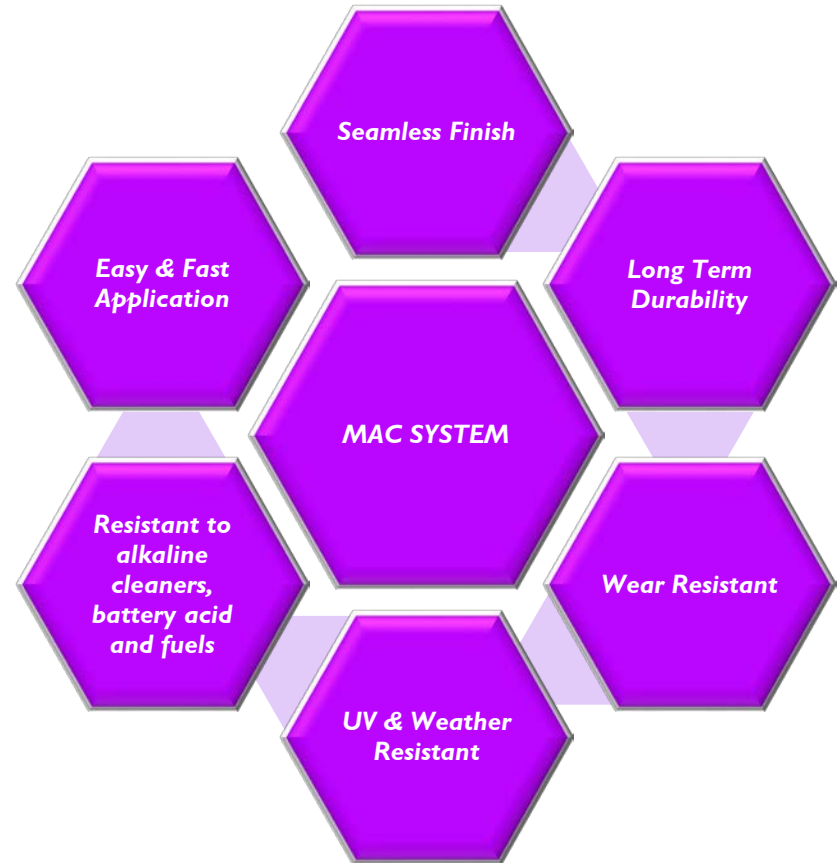

Roof (Flat / Sloped) Balconies / Terraces System Build-up

1. **MAC Primer**
2. **MAC PRECISE**
3. **MAC NEATO**

A fast and easy method for waterproofing Roofs (Flat / Sloped), Balconies & Terraces is using the cold-applied

MAC Waterproofing System.

The solid and clean concrete substrate is primed with **MAC PRIMER RAPID** or **MAC PRIMER OUTLOOK** which provides an excellent bond between the concrete and waterproofing layer.

The wall/floor junction can be easily waterproofed with **MAC PRECISE**.

The standard area waterproofing is done with **MAC NEATO**.

A Top Coat
MAC LACQUER REGULAR or
MAC LACQUER FORTE

protects the waterproofing against mechanical damage.

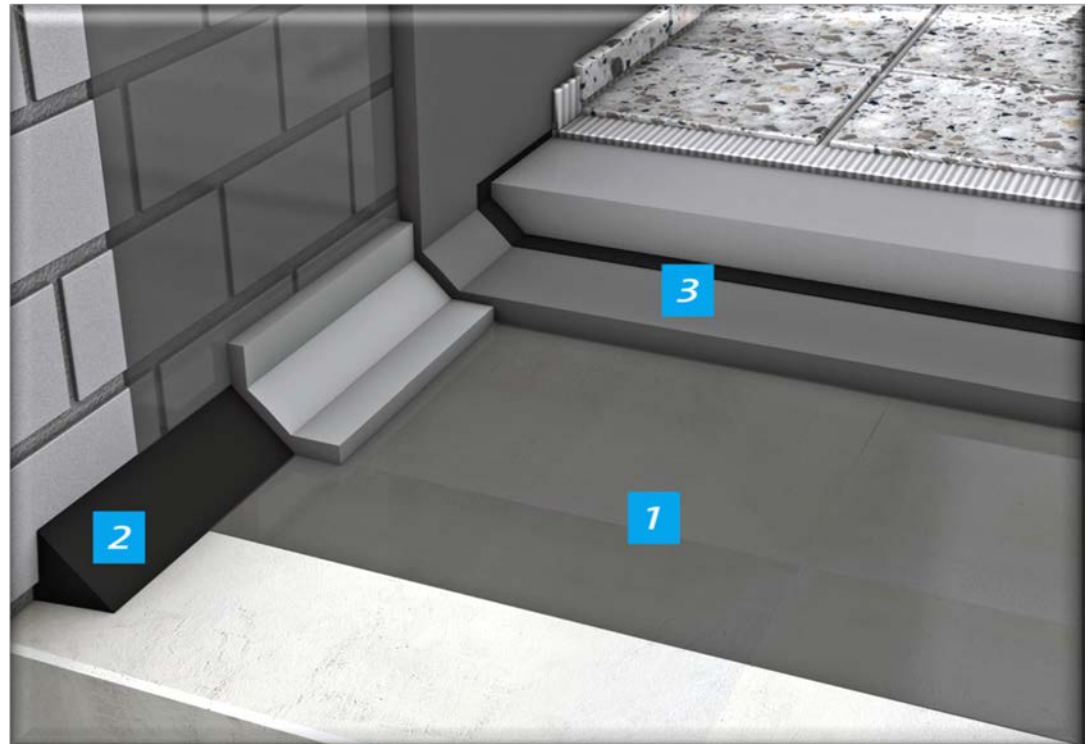

MAC PRIMER RAPID

One component, fast curing (same day) polyurethane based primer suitable for all substrates.

It can be used successfully on both porous or non-porous substrates.

BENEFITS:

One component.

Fast Curing.

Low viscosity.

Easily applied, even on wet concrete.

Excellent wetting, impregnation and paint-over time.

Elastic.

MAC PRIMER OUTLOOK

One component, normal curing, low viscosity, polyurethane based primer suitable for many different substrates

BENEFITS:

EOTA requirements.

One component.

Low viscosity.

Easily applicable, even on wet concrete. Adheres strongly, even on glassy, non-porous substrates.

Excellent wetting, impregnation and paint-over time.

Elastic. Many pigment pastes available. Low-cost solution for concrete sealing & protection.

Roof (Flat / Sloped) Balconies / Terraces System Build-up



09

LIQUID WATERPROOFING MEMBRANE

MAC PRECISE

Thixotropic and fiber-reinforced, one component polyurethane liquid membrane used for waterproofing and protection of roof detail structures **BENEFITS:** *EU guideline for this type of materials, EOTA (European Organization of Technical Approval). No reinforcement necessary in flashing points. Fast curing. Skin formation time of 2 hours. Bubble and defect free membrane. Excellent weather and UV resistance. Excellent thermal resistance. Excellent mechanical properties, high tensile and tear strength, high abrasion resistance. Good chemical resistance.*

LIQUID WATERPROOFING MEMBRANE

MAC NEATO

One component, low viscosity, polyurethane fluid that cures with the humidity in the atmosphere to produce a highly elastic membrane with strong adhesion to many types of surfaces
A 30 years solution for waterproofing and protection
BENEFITS: *CE: ETA-04/0082, No thinning is required, Excellent weather and UV resistance, Excellent thermal resistance, Max service temperature 80 °C, max shock temperature 200 °C, Resistance in the cold, Excellent mechanical properties, Good chemical resistance. Non-toxic after full cure*

Roof (Flat / Sloped) Balconies / Terraces

System Build-up
TOP COAT



MAC LACQUER REGULAR

*Fully aliphatic, one component,
polyurethane fluid*

BENEFITS:

*Excellent weather and UV resistance,
no yellowing (it is fully aliphatic).*

*Excellent mechanical properties, high
elasticity, tensile and tear strength.*

*Highly hydrophobic. Excellent chemical
and hydrolysis resistance.*

TOP COAT

MAC LACQUER FORTE

*One- component polyurethane
coating, that contains specialty
inorganic fillers that offer superior
hiding power*

BENEFITS:

*Excellent hiding power even in one coat.
Traffic resistant. Strong and uniform
adhesion on almost any type of
surface. Highly hydrophobic. Highly
durable when exposed to the natural
elements, maintains its elasticity even
down to -40 oC.*

*Excellent heat and ultraviolet/UV
resistance. Outstanding resistance to
chemicals and mechanical stresses (high*

Foundations / Retaining Walls System Build-up

1. *Primer (If necessary)*
2. *Waterproofing pipe penetrations*
3. *Preparing wall/floor junctions*
5. *MAC ASPHALT*
6. *Drainage Sheet*

The use of bituminous products is a standard solution for positive side waterproofing of Foundations & Retaining Walls. The systems are applied in a paste-like form and are seamless. They are easy and safe to use, and have crack-bridging properties.

Primer is needed to specific substrates.

To protect against water creeping behind the lower waterproofing connections, a layer of MAC ASPHALT

is applied first. To prevent stresses in the waterproofing, fillets can be installed at wall / floor junctions.

The actual area waterproofing is achieved using

MAC ASPHALT

Before backfilling the positive side, waterproofing is to be protected from mechanical damages and settling with Drainage Sheet.

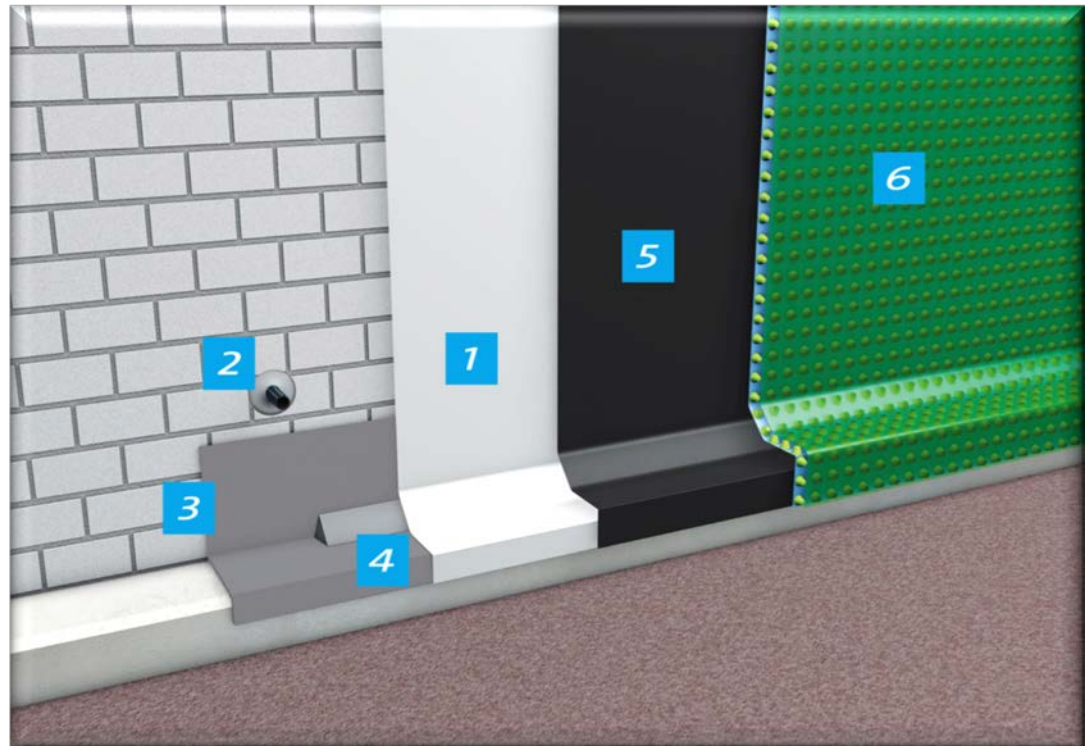

MAC ASPHALT

Fast-curing, two- component, bitumen-extended polyurethane fluid. It produces a highly elastic membrane with strong adhesion to many types of surfaces and excellent mechanical and chemical resistance properties

BENEFITS:

CE: ETA-10/0095, ASTM C836-95, root resistance, compliance / performance. Fast curing. Thick, bubble-free, membrane possible. Its low modulus gives it excellent substrate crack-bridging properties. Excellent adhesion on almost any



Wet Areas System Build-up

1. **MAC PRIMER (Rapid or Outlook)**
2. **Waterproofing corners and wall floor junctions**
3. **Waterproofing outside corners**
4. **Waterproofing inside corners**
5. **Waterproofing wall penetrations**
6. **Waterproofing floor drains**
7. **Waterproofing layer**
SILICA SAND
8. **Tile adhesive**

Few areas are so constantly exposed to water as kitchens and bathrooms. In these rooms, a professional and crack bridging waterproofing material is required which is also stable enough so that tiles can be applied on top of it.

The MAC System is a complete system for waterproofing underneath tiles in wet rooms.

Prime the dry and stable substrate with **MAC PRIMER (Rapid or Outlook)**.

As a waterproofing layer,
MAC NEATO

is applied, in corners and connection areas, at wall / floor junctions and joints.

A layer of sprinkle silica sand must be applied prior of tile adhesive

Always adhere to the specifications in the

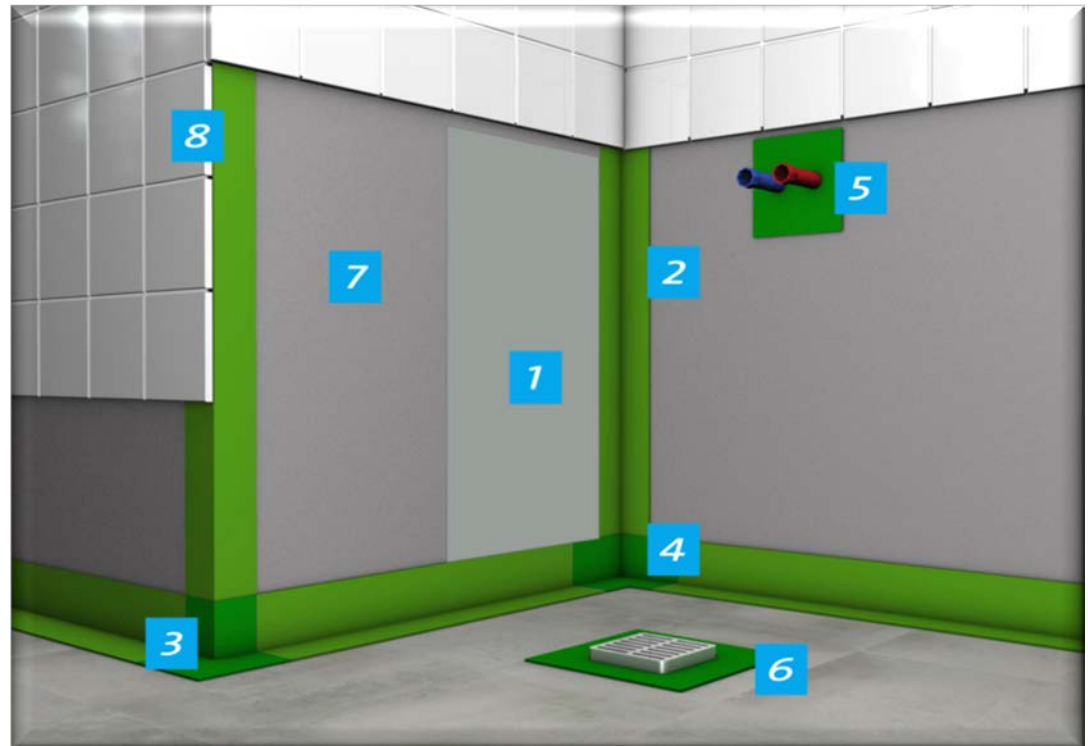

Wet Areas System Build-up

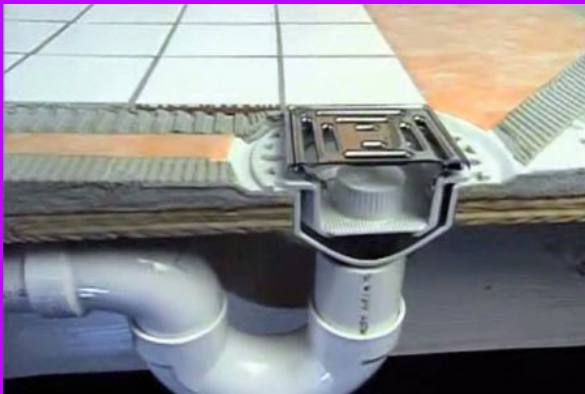

Transparent Waterproofing Balcony System Build-up

1. **MAC PRIMER CRYSTALLINE / SOLID**
or
MAC PRIMER CRYSTALLINE / SPONGY
2. **COLOR CHIPS or COLOR QUARTZ**
(optional)
3. **MAC CRYSTALLINE**

A fast and easy method for waterproofing Balconies / Terraces and decorate them at the same time

*The substrate is primed with
MAC PRIMER CRYSTALLINE
(SOLID or SPONGY)
which provides an excellent bond between the
substrate and waterproofing layer.*

*The standard area waterproofing is done with
MAC CRYSTALLINE*

*An intermediate Decorative Layer with Color Chips
or Color Quartz can be applied*

*Always adhere to the specifications in the respective
Technical Guidelines.*

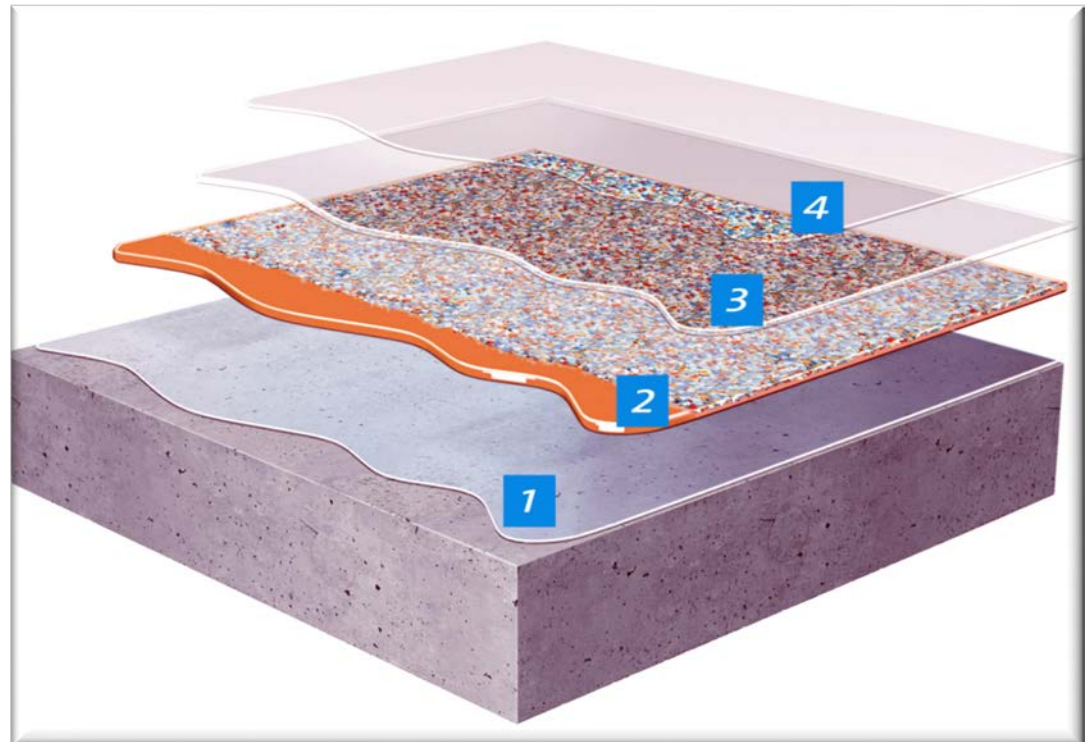

Transparent Waterproofing Balcony System Build-up



MAC PRIMER CRYSTALLINE / SOLID

One component, colorless, non-staining primer especially designed to secure the adhesion of MAC CRYSTALLINE on non-porous substrates

BENEFITS:

*Quick drying. No thinning is required.
Non-Staining. Easy application*

MAC PRIMER CRYSTALLINE / SPONGY

One component, low viscosity, 100% aliphatic polyurethane based primer suitable for all substrates

BENEFITS:

*EOTA requirements. 100% Aliphatic Polyurethane; No yellowing, No staining
One component. Of low viscosity.
Relatively quick curing. Adheres strongly, even on glassy, non-porous substrates.
Excellent wetting, impregnation and paint-over time.
Many pigment pastes available.)*

Transparent Waterproofing Balcony System Build-up



17

TOP COAT

MAC CRYSTALLINE

One component high solids, polyurethane fluid, which cures with the humidity in the atmosphere. It produces an elastic, highly durable, highly hydrophobic membrane with excellent UV resistance.

BENEFITS:

*Excellent weather and UV resistance.
Excellent thermal resistance, the product never turns soft.*

*Resistance to cold even down to -40 °C.
Excellent mechanical properties. Good chemical resistance. Water vapor transmission. Can also be applied in thick, bubble-free, coats.*



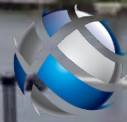

nimaco

*Polymer Bitumen Based
Waterproofing Membranes*

PLASTOBIT

www.nimacochemicals.com

Polymer Bitumen Based Waterproofing Membranes



17

CP 2000 / 3000 – PP 3000 / 4000

PLASTOBIT

Fiberglass-reinforced waterproofing membrane made of bitumen modified with APP (atactic polypropylene), coated with PE (polyethylene) film on the lower and upper surfaces and applied with an oxyacetylene burner.

USES:

- Terrace roofs of buildings
- Sloping concrete roofs,
- Curtain walls, Foundations.
- Designed for moderate climates and used as lower and middle layer membrane in waterproofing.





nimaco

Polymer Bitumen Based Waterproofing Membranes

POLIBIT

www.nimacochemicals.com

Polymer Bitumen Based Waterproofing Membranes

C 2000 / 3000 – P 3000 / 4000

POLIBIT

Fiberglass-reinforced waterproofing membrane made of bitumen modified with APP (atactic polypropylene), coated with PE (polyethylene) film on the lower and upper surfaces and applied with an oxyacetylene burner.

USES:

- Terrace roofs of buildings
- Sloping concrete roofs
- Curtain walls, Foundations.
- Designed for moderate climates and used as lower and middle layer membrane in waterproofing.



***Polymer Bitumen Based
Waterproofing Membranes***

LEVOBIT

Polymer Bitumen Based Waterproofing Membranes



17

CS 220 / 330 – PS 330

LEVOBIT

Fiberglass-reinforced waterproofing membrane made of bitumen modified with APP (atactic polypropylene), coated with PE (polyethylene) film on the lower and upper surfaces and applied with an oxyacetylene burner.

USES:

- Terrace roofs of buildings
- Sloping concrete roofs
- Curtain walls, Foundations.
- Designed for moderate climates and used as lower and middle layer membrane in waterproofing.





**Self-Adhesive Waterproofing
Membranes**

RENOVA UNO

Self-Adhesive Waterproofing Membranes

RENOVA UNO

Elastomeric modified bituminous self adhesive waterproofing membrane. Developed for renovation projects, its one side is self-adhesive, and this product is a special polymer bituminous, polyester carrier, 3 mm thick. Especially in the roof insulation of historic structures which have fire risk, it has a characteristic of being implemented thanks to the fact that it is self adhesive without using torch flame.

USES:

Terraces, roofs and foundations first layer and/or second layer, is used for waterproofing

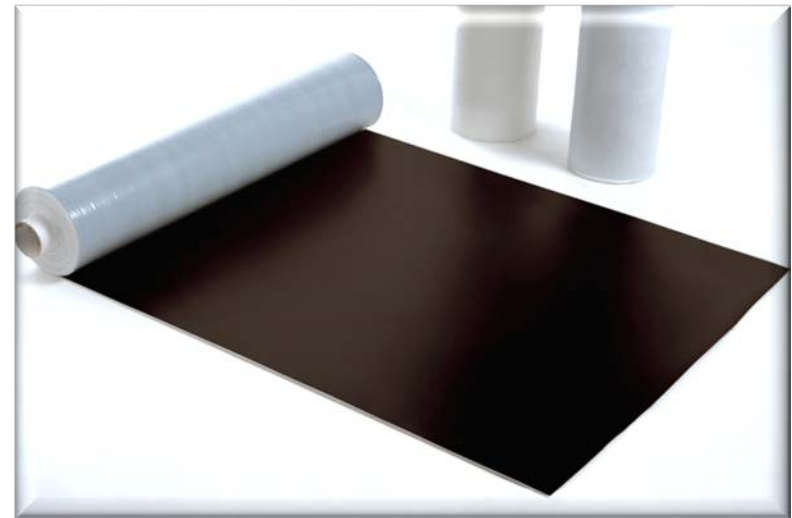



nimaco

*Self-Adhesive Waterproofing
Membranes*

**ELASTOSELF
MD**

www.nimacochemicals.com

Self-Adhesive Waterproofing Membranes

ELASTOSELF MD

Polyester reinforced 1,5mm thick, self-adhesive, cold-applied waterproofing membrane made of bitumen modified by SBS (styrene-butadiene-styrene), with release film underside and fine sand on the upper surface.

USES:

- Terrace roofs,
- Sloping concrete Roofs.
- Ideal material as a first layer membrane for light metallic roofs.

Elastoself MD is not only designed for cold climates, but may also be used as first layer



Thank you for your attention

Have a nice day

